

Kissell Hill area

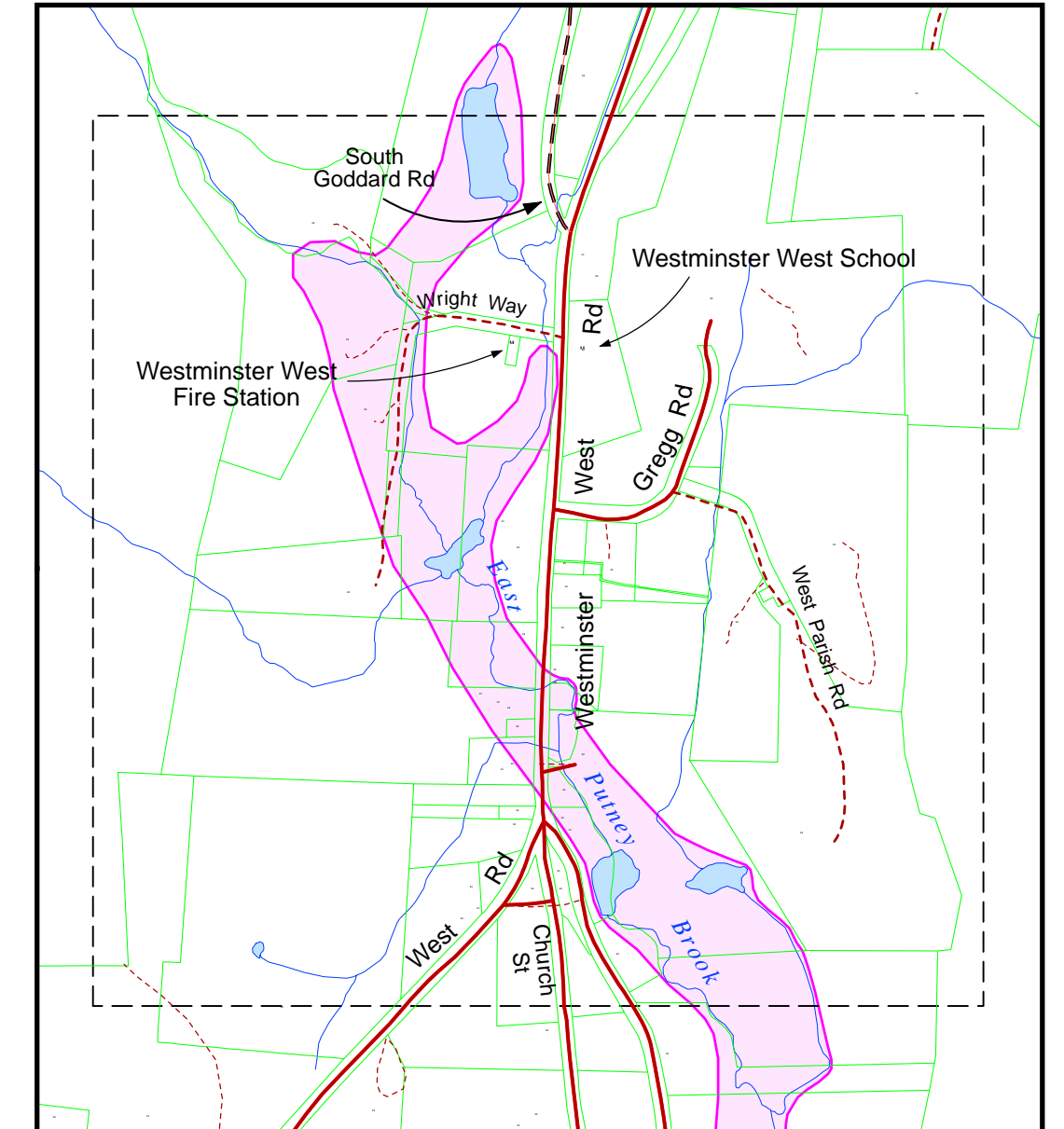

Westminister West

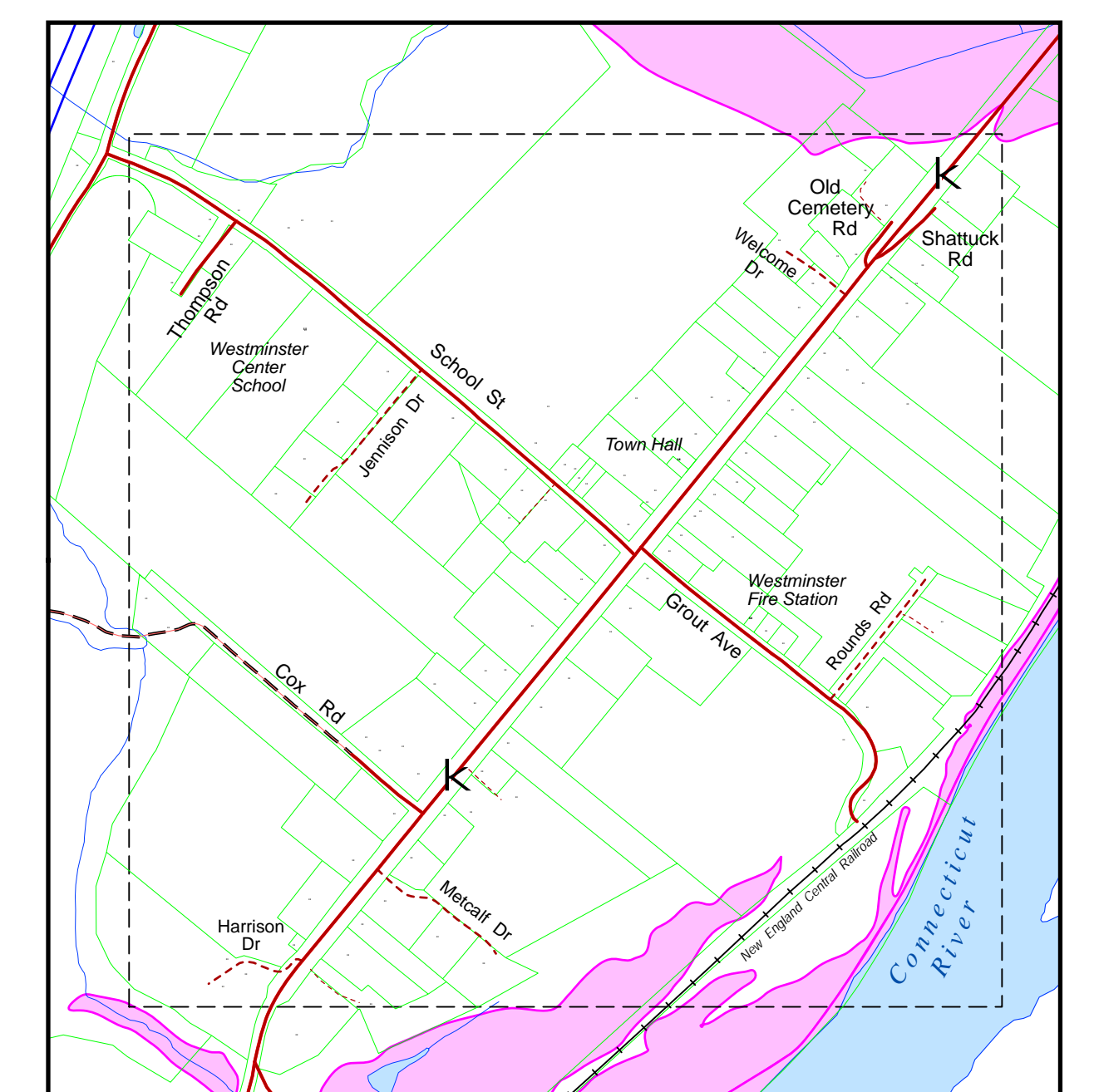

Westminister village

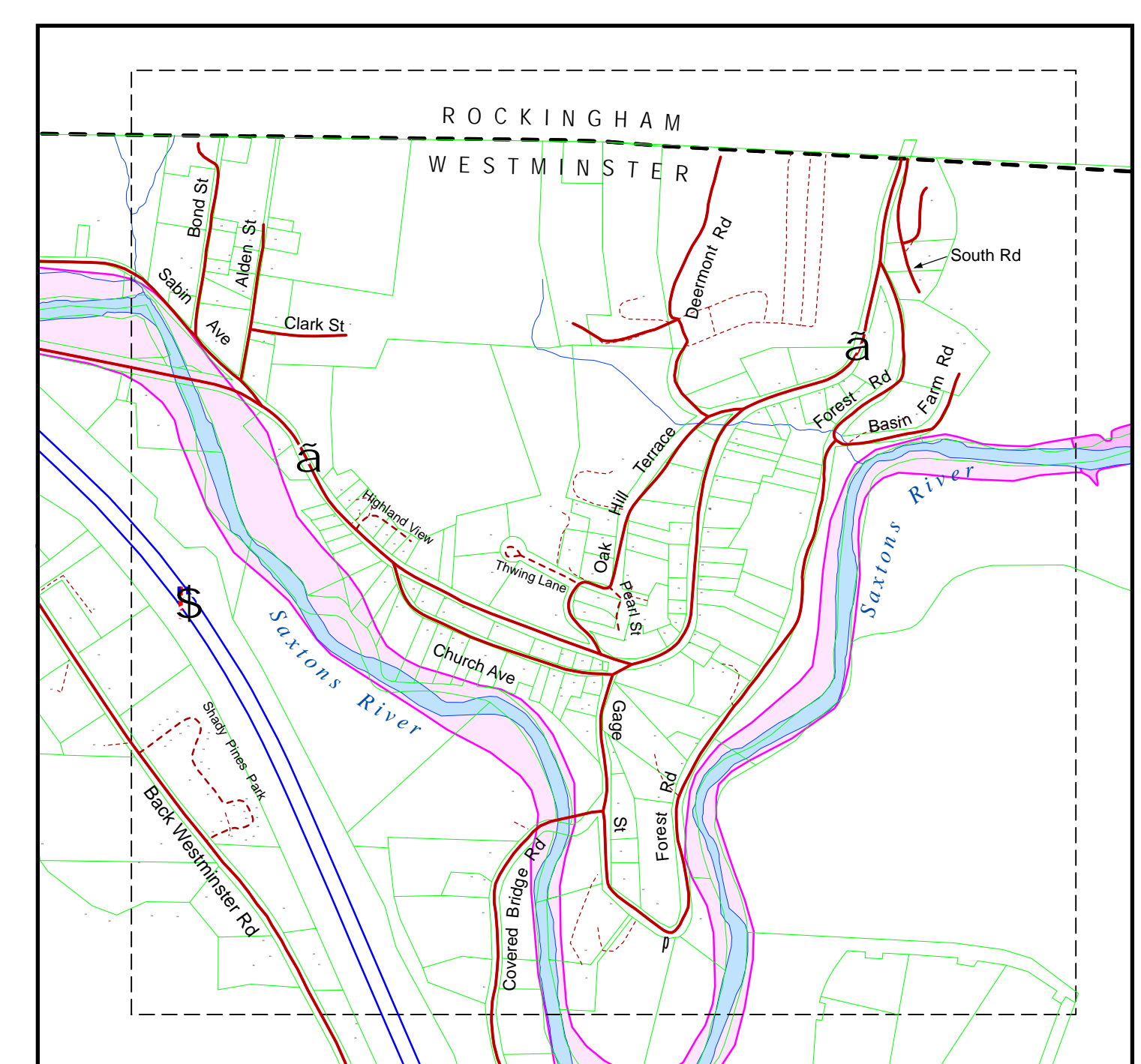

North Westminster (Gageville)

Flood Hazard Areas Town of Westminster, Vt.

flood hazard areas effective September 28, 2007

Note: This map is NOT the official Flood Insurance Rate Map for the Town of Westminster. This map shows D-FIRM (Digital Flood Insurance Rate Map) data with GIS data from Vermont Center for Geographic Information (VCGI) and Windham Regional Commission (WRC). D-FIRM data were produced independent of the other GIS data on this map. Locations of roads, buildings, and parcel lines may not be accurate relative to Flood hazard area boundaries. Use the FEMA Flood Insurance Rate Map for official determinations and for more information on Special Flood Hazard Areas.

- Special Flood Hazard Areas (SFHAs) Subject to Inundation by the 1% Annual Chance Flood
- (Zone AE - Base Flood Elevations determined)
 - (Zone A - No Base Flood Elevations determined)
 - US or State Highway
 - Interstate Highway
 - Class 2 or 3 town highway
 - Class 4 town highway - unpaved
 - Legal Town Trail
 - Private road/drive
 - Town boundary
 - Parcel boundary
 - Driveway
 - Electric transmission line
 - Structure
 - Stream
 - River or pond

Data sources:

- Special Flood Hazard Area data boundaries are from FEMA (Federal Emergency Management Agency) D-FIRM (Digital Flood Insurance Rate Map) data created on July 27, 2007.
- Parcel boundary data were developed by WRC using ArcEditor software to convert and edit DXF data of the Town's 2005 tax maps from DiBemando Associates, Bellows Falls, VT.
- Primary structure locations were captured using Global Positioning System technology by microDATA, St. Johnsbury, VT for Vermont's Enhanced 9-1-1 program. Locations have been edited by Windham Regional Commission in 2005 using 2000 Vermont digital orthophotos, 2003 National Agricultural Imagery Program orthophotos, and information from the Town of Westminster.
- Accessory structure locations were developed by Windham Regional Commission using data first created in conjunction with the Town of Westminster in 1994, then updated in 2005 using 2000 Vermont digital orthophotos, 2003 National Agricultural Imagery Program orthophotos, and information from the Town of Westminster.
- Highway data are from VI Agency of Transportation sources (VGIS data layer RDS00mm). Data were corrected and updated by Windham Regional Commission in 2006 using Vermont digital orthophotos and information provided by the Town of Westminster.
- Highway attributes (i.e. class and pavement) are from AOT highway maps. These data were corrected by WRC GIS staff in 2006 using information provided by the Town of Westminster.
- Railroad data were taken from VGIS data layer RR. These data were developed by digitizing railroad centerlines from 1:5000 orthophotos.
- Surface waters are from the Vermont Hydrography Dataset (VGIS data layer SW000mm). The dataset was generated at a scale of 1:5000 and was developed using digital orthophotos, topographic maps, color infra-red aerial photography and other ancillary data sources.

